

BULLETIN # 2 - CHICANES

The following page has drawings of the chicane layouts. The large pylon is as shown below; the smaller ones are standard 14" high ones.

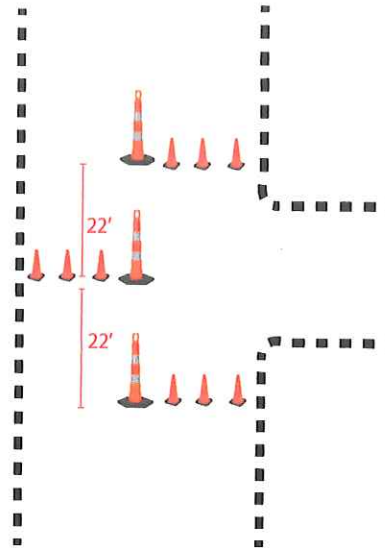

Apex Pylon



CHICANES ON S. ARM N.

It is not the intention of the organizers to create a scoring debacle, but to slow the cars down commensurate with RA rules.

It is the intention of these chicanes to get competitors down into first gear to negotiate them.

Penalties: (as ruled by the judge of fact at the chicane)

10 seconds = dislodging or knocking over of an element

30 seconds = for putting 2 wheels on the wrong side of the large pylon (similar to straddling a gate in a slalom)

60 seconds = for complete disregard of the chicane.

CHICANES con't

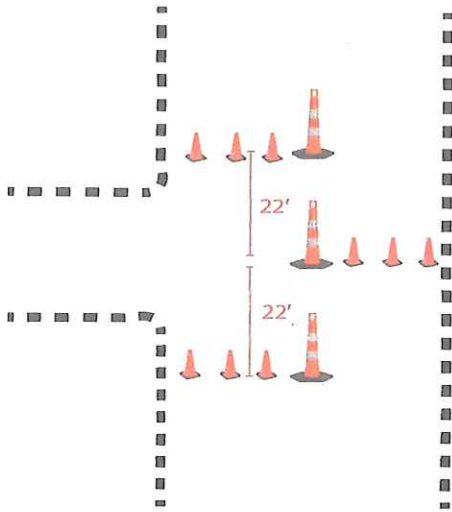

2 CHICANES ON ICILE BROOK S.

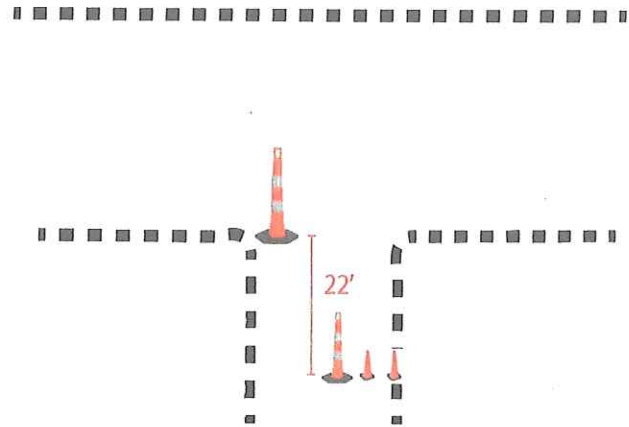

CHICANE AT MILEAGE 11.46 ON ICILE BROOK S.

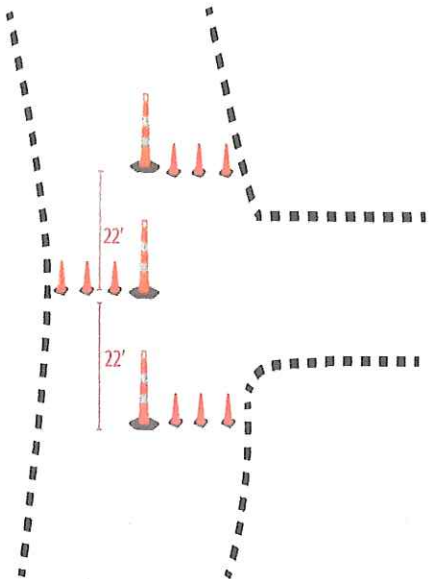

CHICANE AT MILEAGE 3.88 ON B17

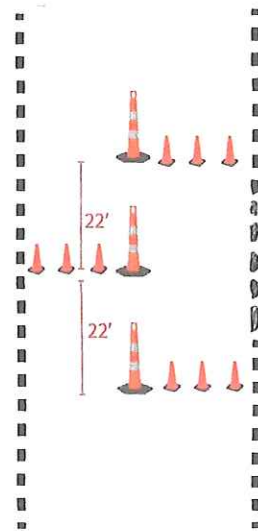

CHICANE AT MILEAGE 4.62 ON B17